

# DIRECTA ceramir® | Ceramir CAD/CAM BLOCKS

## Step by Step Guide

Brought to you by  
**DIRECTA USA**  
A Division of DirectaDentalGroup | [directausa.com](http://directausa.com)

### Preparation of the restoration



**1**  
Remove the restoration  
from the attachment  
with a diamond bur

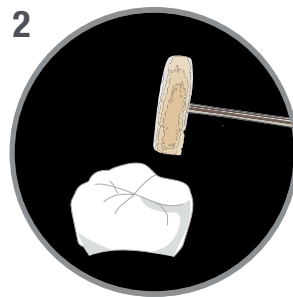

**2**  
Final polish  
with goat hair brush and  
cotton / linen buffs

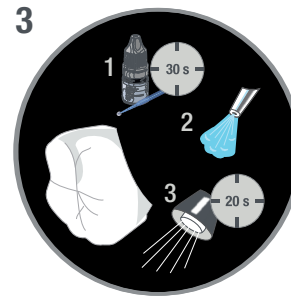

**3**  
Prepare restoration  
1. Apply a very thin layer of edelweiss VENEER  
BOND to inner surface, rub surface for 30 sec  
2. Dry surface with air  
3. Light cure for 20 sec  
(Or apply equivalent bonding/primer and use it  
according to manufacturer's instructions.)

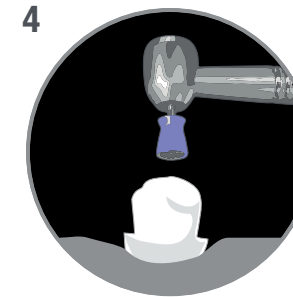

**4**  
Clean the tooth  
with polishing paste free from  
oil and fluoride

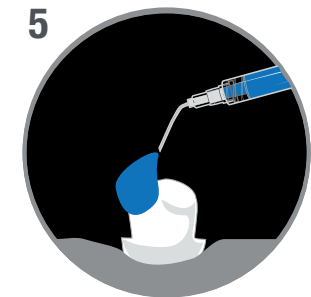

**5**  
Apply  
37% phosphoric acid  
(Enamel 15-30 sec/  
Dentin 15 sec)

### Preparation of the tooth



**6**  
Rinse with water and  
gently dry the surface

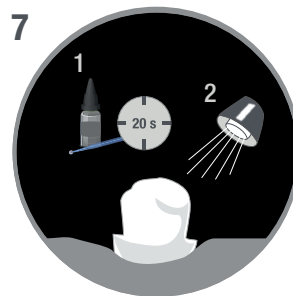

**7**  
Prepare tooth  
1. Apply dentin bonding (Rub surface  
with dentin bonding for 20 sec.)  
2. Light cure  
(according to manufacturer's IFU)

### Seating of the restoration

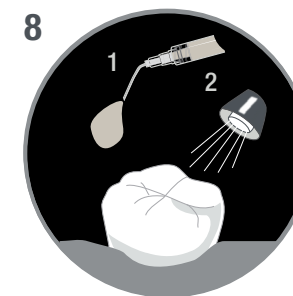

**8**  
Cementation  
1. Apply adhesive resin cement/  
composite into restoration  
and seat restoration  
2. Light cure  
(according to manufacturer's IFU)



**9**  
Remove excess cement